

ORIENTATION:

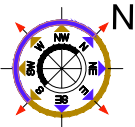

SCHEDULE OF OPENINGS:

SL NO	DETAIL	SIZE	CILL	SPECIFICATION
1	ED	3000X3000	FFL	GLASS
2	D1	1800X2400	FFL	HONNE WOOD
3	D	1200X2400	FFL	HONNE WOOD
4	D2	1050X2100	FFL	HONNE WOOD
5	D3	900X2100	FFL	WPC
6	D4	2400X2400	FFL	HONNE WOOD
7	W1	1800X1800	900	UPVC
8	W	2400X1800	900	UPVC
9	W2	1200X1800	900	UPVC
10	W3	1800X1500	900	UPVC
11	V	4500X750	LINTEL :BB	UPVC
12	V1	1800X750	LINTEL :BB	UPVC
13	V2	3000X750	LINTEL :BB	UPVC
14	V3	2400X600	LINTEL :BB	UPVC
15	V4	900X750	LINTEL :BB	UPVC
16	RS	4000X3900	LINTEL :SB	M.S
17	SD	1200X2100	FFL	WPC
18	FG	3000X2100	FFL	FIXED GLASS

VERIFIED BY

MANAGER-PROJECT
GT&TC

DY.MANAGER-PROJECT
GT&TC

CLIENT:



GOVT.TOOL ROOM AND TRAINING CENTRE
RAJAJINAGAR INDUSTRIAL ESTATE, BANGALORE-560010

PROJECT:

ESTABLISHMENT OF NEW GTTC CENTRE AT
SINDHANOOR IN RAICHUR DISTRICT.

CONSULTANTS:

NC NAVEEN CONSULTANTS
ARCHITECTS & ENGINEERING CONSULTANTS
1398, 2nd floor, 2nd Cross, Ashoka Nagara
(Behind B.M.S Engineering College Hostel)
Banashankari 1st Stage, Bangalore-560050
PH-080-26620836 (o), Fax-26620836,
Email- naveenconsultants@gmail.com,
naveenconsultant1@gmail.com

TITLE:

TRAINING BLOCK WITH WORKSHOP BLOCK

DRAWING:

FIRST FLOOR PLAN

DRAWN BY : BASANTI DATE : 26/09/2025

DESIGN BY : KVNS SCALE : NTS

CHECKED BY: KVNS SHEET : A2

DWG NO:

NC4-2022-6TTC-SINDHANOOR TB02

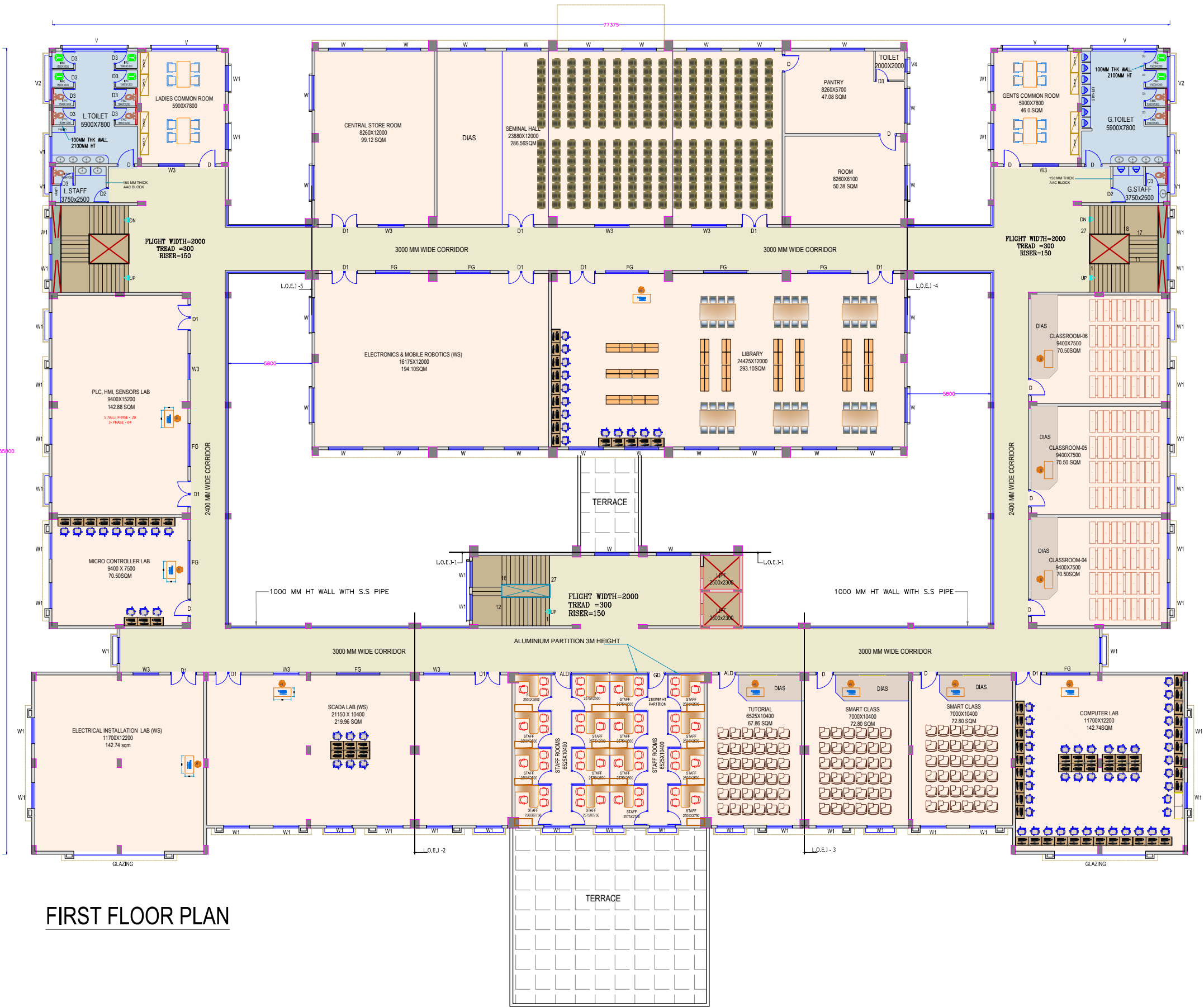

FIRST FLOOR PLAN